

Product Specification

Modeling Profile

WW-AP1003

HK Office :

Unit 1901, 19th Floor, NanYang Plaza, No. 57 Hung To Road
Kwun Tong, Kowloon, Hong Kong

Tel : (852) 3152 3059 (10 lines) 

Fax : (852) 3152 3039 

China Factory :

Zhiyang Science and Technology Park, 10 Zhiyang Road, Zhangge,
Fucheng Street, Longhua District, Shenzhen, Guangdong, China

Tel : (86) 755 8601 9190

Fax : (86) 755 8601 9197

WW-AP1003-XXX

Features

- Adopt aviation aluminum 6063-T5, outstanding heat dissipation performance.
 - High quality surface finish with silver, white or black.
 - No screw tight front-end cap, with hole & without hole front-end cap options.
 - Uniform illumination
- Easy installation



Dimension Drawing

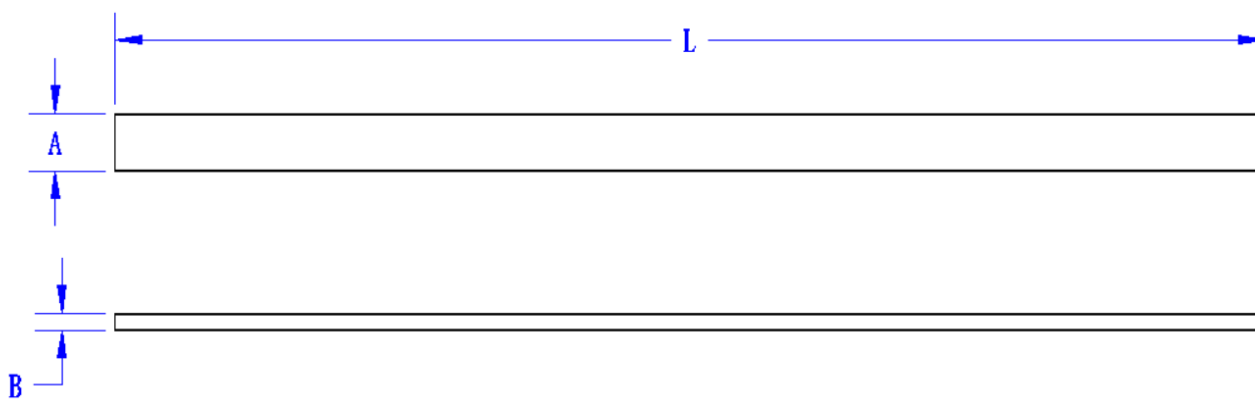

WW- AP1003-212					
A	B	L			
3±0.2mm	10±0.2mm	2120±2mm			
0.12±0.008in	0.39±0.008in	83.46±0.079in			

WW-AP1003-100					
A	B	L			
3±0.2mm	10±0.2mm	1000±2mm			
0.31±0.008in	0.39±0.008in	39.37±0.079in			

Exploded views

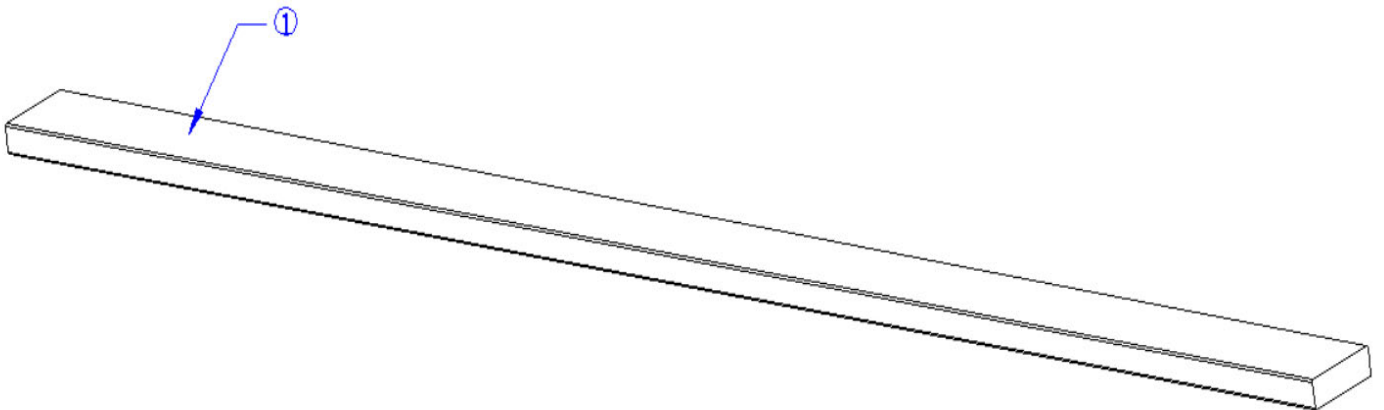

Standard parts

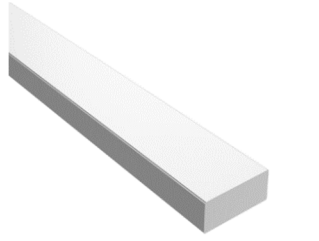
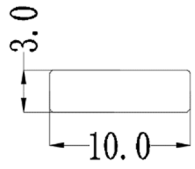
	Picture	Product name	Market model	Product size	Characteristics
①		Aluminum profile	AP1003-LC		6063-T5

Remarks:

- Because PC material has expansion and contraction feature, the linear expansion coefficient of PC material is $7 \times 10^{-5} \text{ cm/cm} \cdot ^\circ\text{C}$, so when the product be used in different ambient temperatures, the length of PC cover will has a little bit tolerance which can be calculated by formula.
- For example: the original length of PC cover is 2 meters, when it has been used in 0°C ambience temperature, the length of PC cover will probably contract 0-5mm. when it has been used in 35°C ambience temperature, On the contrary, the length of PC cover will probably expand 0-5mm.

Optional Accessories

	Picture	product name	model	Product size	Features
⑥		power supply	LS-60W-24	392*31*23mm	EU Plug Input Volt: AC200-240V Output Volt: 24VDC Wattage: 60W Efficiency: 86% PF: ≥0.9 Dimming Method: RX/PWM/0-10V Dimming
⑦			LS-60W-24-UL	392*31*23mm	US Plug Input Volt: AC100-277V Output Volt: 24VDC Wattage: 60W Efficiency: 86% PF: ≥0.9 Dimming Method: RX/PWM/0-10V Dimming
⑧			LS-100W-24	393*34.5*27mm	EU Plug Input Volt: AC200-240V Output Volt: 24VDC Wattage: 100W Efficiency: 86% PF: ≥0.9 Dimming Method: RX/PWM/0-10V Dimming
⑨			LS-100W-24-UL	393*34.5*27mm	US Plug Input Volt: AC100-277V Output Volt: 24VDC Wattage: 100W Efficiency: 86% PF: ≥0.9 Dimming Method: RX/PWM/0-10V Dimming

■ Packaging Diagram

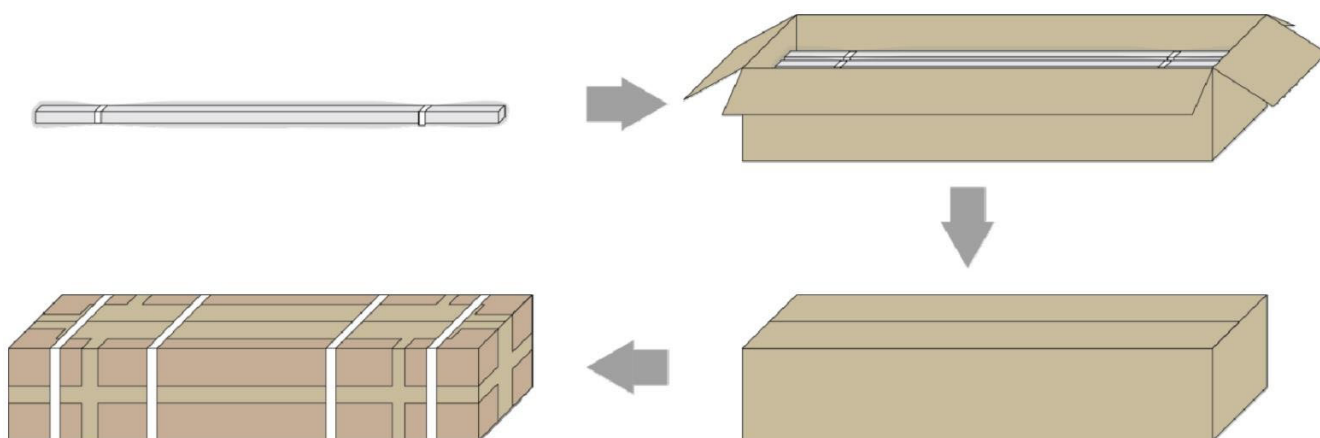

Part NO.	Outer carton		PCS /ctn	N.W		G.W		Outer carton volume	
	Size								
WW-AP1003-100	1060*225*105mm	41.73*8.86*4.13in	140	10.4KG ±10%	22.93Lbs ±10%	11.4KG ±10%	25.13Lbs ±10%	0.02504m ³	0.884 ft ³
WW-AP1003-212	2260*225*105mm	89*8.86*4.13in	140	22.0KG±10%	48.5Lbs ±10%	27.0KG ±10%	59.52Lbs ±10%	0.0534m ³	1.886 ft ³

Remark:

- Packaging information is for reference only, shipping is subject to actual condition.

 **Cautions**



Do not use in a wet or dusty environment



Do not use in places with oil or corrosive substances



Do not pull and collide when the product is working



Install the product in an appropriate environment



Follow user manual for installation



During the warranty period, only defective products are acceptable to be replaced by the factory. Factory is not responsible for other expenses because of replacement, such as transportation fee, installation fee, etc..

**** If you do not follow the above "Cautions" to operate and result in damaging the product, the factory will not accept maintenance and return.**

****he right of final interpretation is owned by Dilux.**